

**MODULAR NOW<sup>®</sup>**  
**PRINTER TRAY WALL MOUNTS**  
POINT-OF-SALE



**HAT**  
**DESIGN WORKS™**  
HUMAN ACTIVE TECHNOLOGY

# A FLEXIBLE MOUNT FOR PRINTERS.

Our Modular Now printer tray wall mounts feature durable construction and flexible positioning.



## FEATURES

- **Robust:** Sturdy mount with adjustable rotation friction secures printer to wall while allowing for flexible positioning.
- **Aesthetic:** Cables can be routed underneath extension arm for a clean look.
- **Customizable:** Add additional extension arms to increase reach.

## SPECIFICATIONS

### Finishes

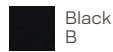

Black  
B

### Dimensions

Tray Sizes:

MNTR11-WM-08B: 5.5" W x 5.8" L

MNTR10-WM-08B: 5.7" W x 7.7" L

MNTR12-WM-08B: 10.3" W x 10.8" L

Extension Arm Length: 8"

### Part Numbers

MNTR11-WM-08B

MNTR10-WM-08B

MNTR12-WM-08B



MNTR11-WM-08B



MNTR10-WM-08B



MNTR12-WM-08B

## WARRANTY

10 Years

CAPABILITIES

MNTR11-WM-08B

MNTR10-WM-08B

MNTR12-WM-08B

Mount  
(All Models)

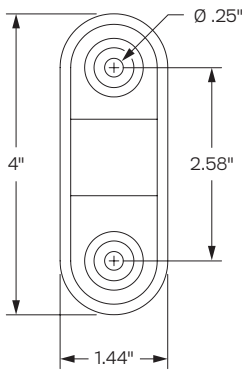

DIMENSION DRAWINGS TO COME